

CUBE2, CUBE4 PENDANT STEM INSTALLATION INSTRUCTIONS

POWER CABLE INSIDE STEM

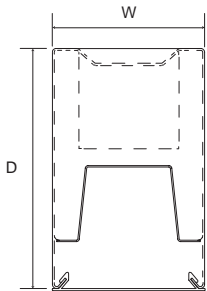

Specifications: CUBE2

Width: 2.5 (64)
Depth: 4 (101)

All dimensions are in inches
(millimeters).

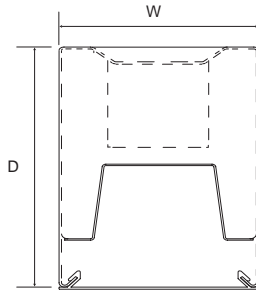

Specifications: CUBE4

Width: 4 (101)
Depth: 4 (101)

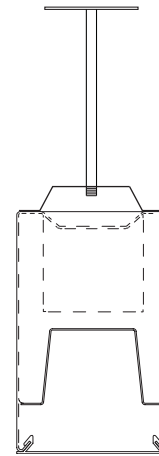

Stem

PART LIST

- | | | |
|------------------|-------------------|--------------------|
| A: Stem | G: Stem bracket | M: Wire connectors |
| B: Threaded stud | H: Bracket screws | N: Screws |
| C: Canopy | I: Wire Nuts | |
| D: J-box bracket | J: Trim ring | |
| E: Screws | K: Power cable | |
| F: J-box | L: Bushing | |

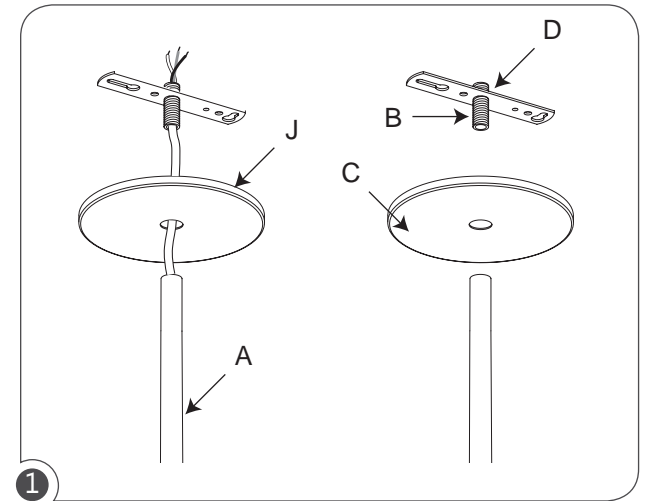

1 Run power cable through stem(A). Slide the trim ring(J) and then the canopy(C) onto the stem and leave loose. Screw the j-box bracket(D) with the threaded stud(B) onto the stem.

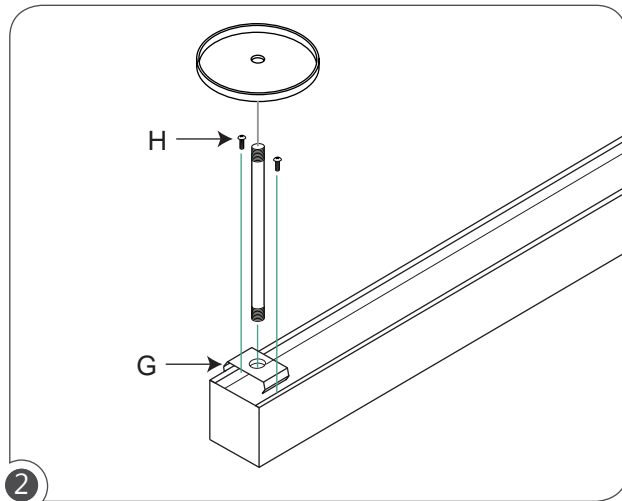

2 Screw stem bracket(G) to housing with Bracket screws(H). Then Screw the stems onto the stem bracket with mounting nut at each end of the fixture.

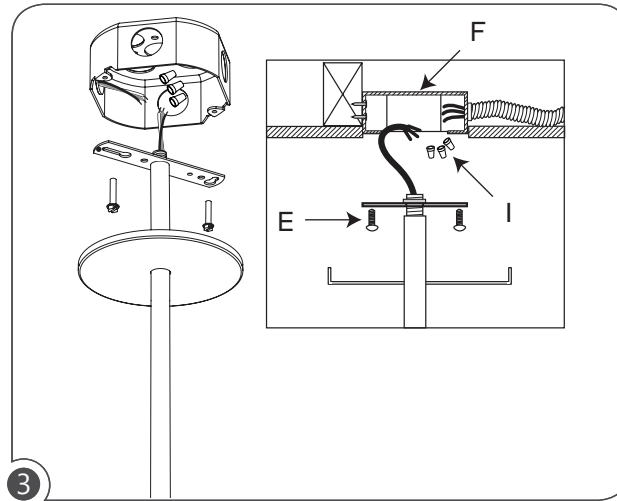

3 Align the power side of fixture to the j-box(F) and rise to ceiling and secure with screws(E) the j-box bracket to the junction box. Make electrical connection with wire nuts(I). Slide the canopy and secure in place with the trim ring.

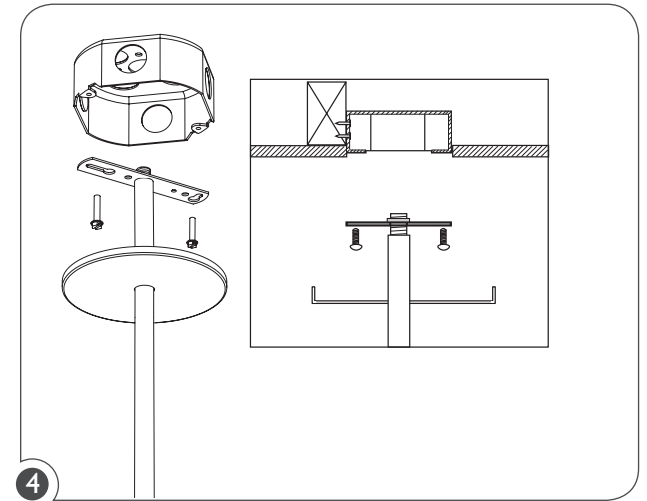

4 Align the non power side, raise the fixture to the ceiling and secure with screws the j-box bracket to the junction box. Slide the canopy and secure in place with the trim ring.



CUBE2, CUBE4 PENDANT STEM INSTALLATION INSTRUCTIONS

POWER CABLE INSIDE STEM

CONTINUOUS ROW

TOOL(S) NEEDED:

Option 1) Cordless drill and an elbow or L-shape adapter with Philips Insert Bit extension.

Option 2) Flexible Screwdriver with Philips Insert Bit.

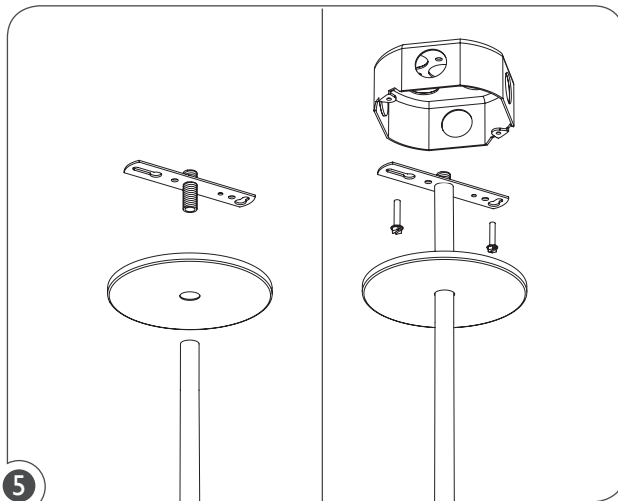

5 For continuous row, After first fixture is placed follow step 1 through 4 for the next fixture.

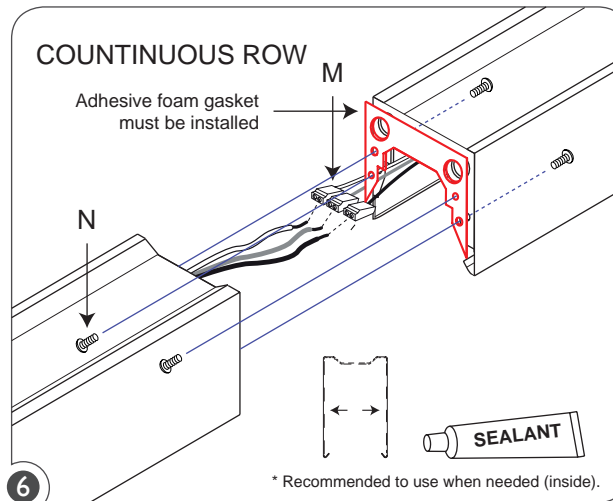

6 Align fixtures make wire connection using wire connectors(M) and screw fixtures together from inside using screws x4(N).



CUBE2, CUBE4 PENDANT STEM INSTALLATION INSTRUCTIONS

CONTINUOUS ROW

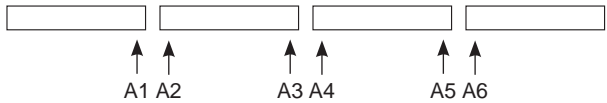

Continuous Row

Align continuous row fixtures in numerical order under the same alphabet family.

* Recommended distance of stems for continuous row.

